

Spindle Holder

GD Series Spindle Integration (Vertical Mount)

- ▲ Built-in rotary cylinder, no need to install additional rotary cylinder.
- ▲ Clamping repeatability within 0.005mm.
- ▲ Maximum speed 3500rpm.
- ▲ Internal support and external clamping can be used, and the clamping jaws can be changed for different workpieces.
- ▲ Small size, large through-hole.
- ▲ Suitable for thin-walled and fine workpiece clamping, fine adjustment of clamping force.
- ▲ Dustproof and waterproof, long service life.



Specification:

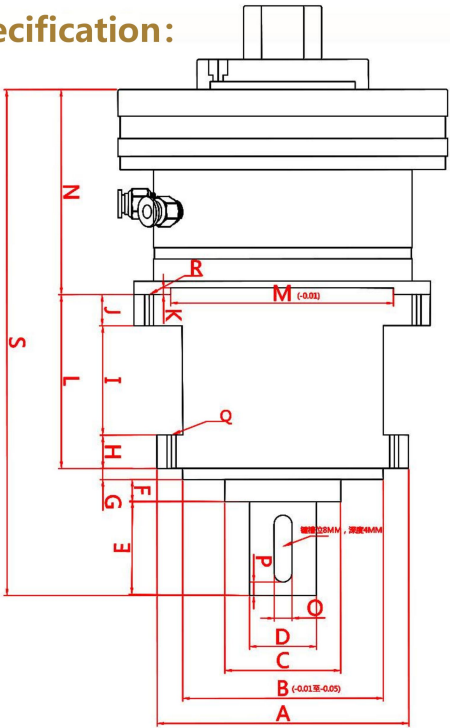

Item	GD-30 spindle	GD-65 spindle
A	113	165
B	90	140
C	52	65
D	30	50
E	42	35
F	10	15
G	5	10
H	15	10
I	49	58
J	14	10
K	3	3
L	78	78
M	100	150
N	92	112
O	8	8
P	4	4
Q	M6*6 (pcd100)	M8*6 (pcd155)
R	M6*4 (pcd120)	M8*4 (pcd180)
S	227	250
Max through	30mm	65mm
Gripper	JD-30	JD-65
Max rotary speed	2500rpm/min	2000rpm/min
Accuracy	0.005mm	0.005mm
Operation pressure	3-8kgs/cm ²	3-8kgs/cm ²
N.W		