

Stationary Air Collet Chuck

DAS-MT8 Small Stationary Collet-Forward Push Type

DAS-MT8 is a cylinder front mounted small fixed chuck, no additional cylinder/oil cylinder installation, body accuracy within 0.01mm, clamping repeatability within 0.03mm, slide forward to lock the workpiece, with T8 simple clamps. Maximum through-hole clamping 8mm, the volume of the fine cylinder, a studio can accommodate a number of small fixed collets. Suitable for use in multi-station tooling, clamping micro-small workpiece clamping, drilling and tapping welding, etc., steel collet body, long service life, dustproof and waterproof.

- Steel collet body for long life
- Small mounting outside diameter (50mm)
- Maximum through-hole clamping 8mm
- Clamping repeatability within 0.03mm
- Built-in pneumatic cylinder, the sleeve of the front push clamping
- Suitable for all kinds of small drilling and milling table



Specification :

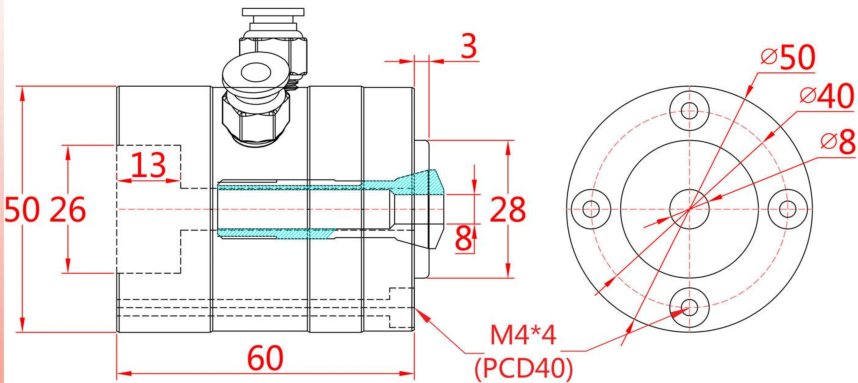

Item	Collet	Max through hole	Accuracy	Clamping force	Operatio npressure	N.W
DAS-MT8	T8 Collet	8mm	0.03mm	100kgf@7kgs/cm	3-8kgs	0.75kgs