

Diaphragm Stationary chuck

GXD Stationary Diaphragm Air chuck



GXD Stationary Diaphragm Air chuck is special designed for automatic equipments , suchas CNCengraving machine, drilling machine, milling machine and other special equipmentit is using for all kinds ofCNC process center , most suitable the light, small &thin work-piece, just like aluminium tube, brass tube, etc, operating with no movement, non-deformation, the ontology accuracy is less than 0.005mm, high precision,simple construction, easy to install, different work-piece only need to change thedifferent jaws, improving the efficiency of volume production and saving cost.

- ▲ Steel body
- ▲ Max through-hole up to 65mm
- ▲ Gripping force can be adjusted according to the enter pressure
- ▲ High precision,longlife, high rigidity, low chassis
- ▲ One chuck double use,use forinner expanding and outer clamping
- ▲ No need to revise the accuracy when change the vice jaws
- ▲ Using for light, thin and small work-piece
- ▲ No movement,non-deformation
- ▲ Highly dustproof and waterproof

Specification:

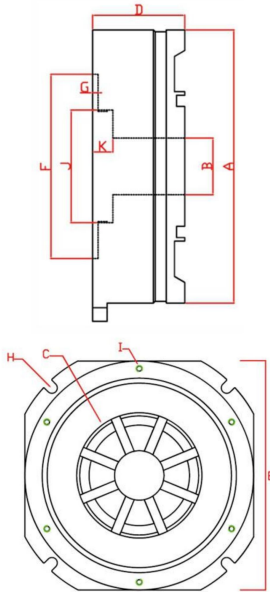

Item	GXD-10	GXD-30	GXD-65
A	80	148	208
B	10	30	65
C	JD-10	JD-30	JD-65
D	50	50	60
E	90	148	208
F	60	100	150
G	3	3	4
H	pcd102	pcd160	pcd225
I	pcd72	pcd138	pcd200
J	/	M61*P1.5	M100*P1.5
K	/	11	17
Installation Screw	4H-M6*15	4H-M8*20	4H-M8*25
Max through hole	10mm	30mm	65mm
Accuracy	0.005mm	0.005mm	0.005mm
Operatio npressure	3-8kgs	3-8kgs	3-8kgs
N.W	2kgs	5.5kgs	12kgs