

GCB series fixed pneumatic chucks

GCB series is a cylinder front fixed pneumatic chuck, using the original German rubber collets, clamping workpiece without deformation, good sealing, fast and easy to clamp, with a special wrench to achieve fast clamping, improve efficiency, clamping repeatability of 0.005mm, the maximum through-hole clamping 65MM, suitable for a variety of high-precision machining clamping, such as machining centers, four-axis and five-axis automation. Equipments

- Quick clamping with rubber clamps
- Cylinder front mounted structure, no need to install additional cylinders.
- Clamping repeatability within 0.005mm.
- Large through-hole, maximum clamping 65mm
- Dustproof and waterproof (under inflatable condition)
- Suitable for all kinds of precision parts machining, drilling, tapping, CNC machining centers, etc.

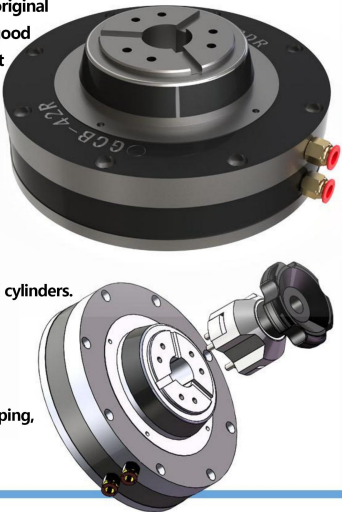

Specification:

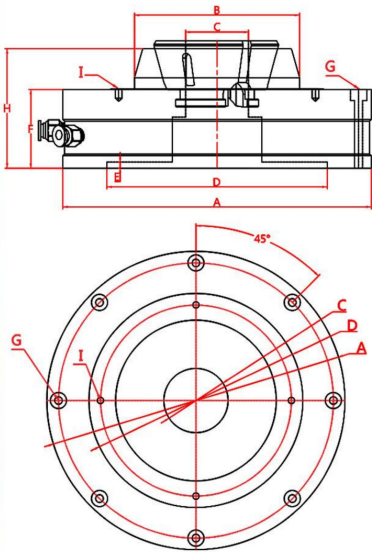

Item	GCB-42R	GCB-65R
A	196	256
B	105	125
C	42	65
D	140	200
E	4	4
F	50	50
G	M6*8 (pcd180) counterbore hole	M8*6 (pcd237) counterbore hole
H	75	77
I	M5*4 (pcd125) Screw hole	M5*4 (pcd145) Screw hole
Max through hole	42mm	65mm
Accuracy	0.005mm	0.005mm
Collet	SS42	SS65
Operatio npressure	3-7kgs/cm²	3-7kgs/cm²
Clamping force	4000kgf@7kgs/cm²	5500kgf@7kgs/cm²
N.W	10.5kgs	17.5kgs